

'Freshwater' 1 Freshwater Place, Southbank



This new luxury apartment is superbly furnished and includes a full kitchen with European appliances, one bedroom, separate bathroom and an open-plan living area opening out onto a balcony with stunning views of the city.

In addition to the general building features of a pool, fully equipped gymnasium, sauna, spa, steam room, massage room, BBQ area, ½ acre garden and fully equipped business centre, this apartment also offers access to the Skyrise Facilities on level 40 – with stunning views across Melbourne and a separate media room.



Freshwater Place's riverfront position is one of the best in Melbourne. Located on the southern bank of the Yarra River between Southgate and the Crown Entertainment Complex, these apartments provide magnificent views over the river, city and Melbourne's parks and gardens.

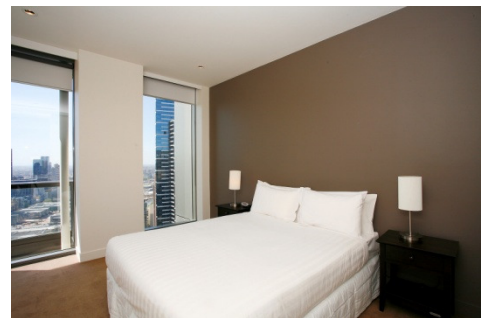

'Freshwater' 1 Freshwater Place, Southbank



K113, 63 Turner Street
Port Melbourne VIC 3207
Ph: +61 3 9279 7200
Fax: +61 3 9646 0474
www.corporatekeys.com.au

Property Profile

‘Freshwater’
1 Freshwater Place, Southbank

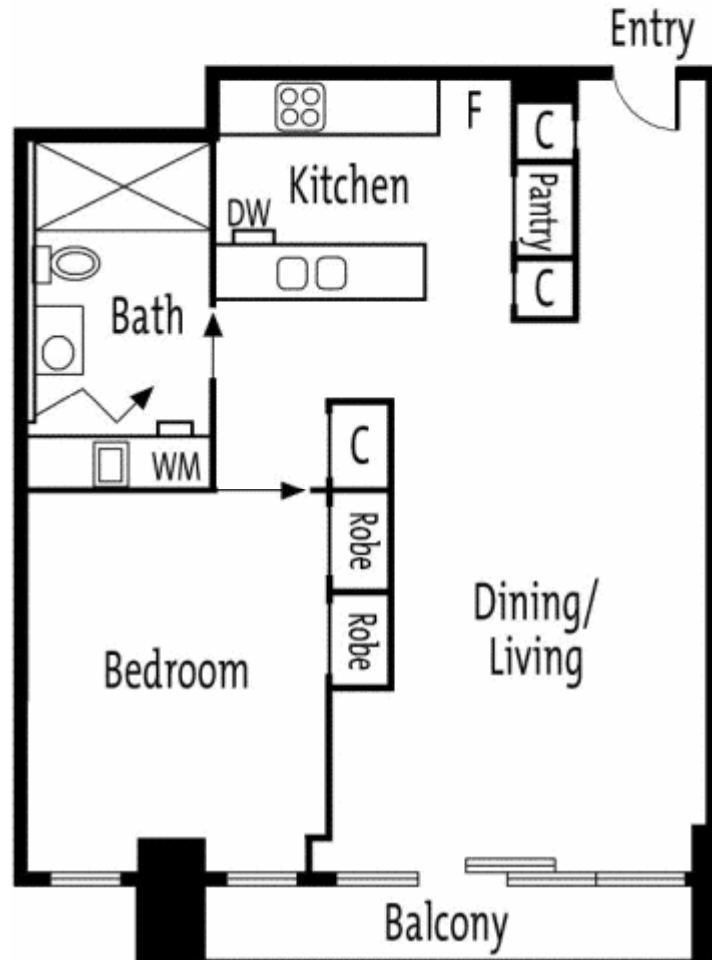

K113, 63 Turner Street
Port Melbourne VIC 3207
Ph: +61 3 9279 7200
Fax: +61 3 9646 0474
www.corporatekeys.com.au