

## “Freshwater” 1 Freshwater Place, Southbank



Freshwater Place's riverfront position is one of the best and most sought after in Melbourne.

Located on the southern bank of the Yarra River, between Southgate and the Crown Entertainment Complex, these apartments provide magnificent views over Melbourne.



This new luxury apartment is superbly furnished and includes a modern galley kitchen with European appliances, one bedroom with ensuite and an open-plan living area opening out onto a balcony with river and city views.

The building features a pool, fully equipped gymnasium, sauna, spa, steam room, massage room, BBQ area, ½ acre garden and fully equipped business centre. Secure car parking is subject to availability.



Weekly rental includes all utility connections and ongoing usage charges, telephone connection and line rental including unlimited local & national telephone calls.



**‘Freshwater’**  
**1 Freshwater Place, Southbank**



K113, 63 Turner Street  
Port Melbourne VIC 3207  
Ph: +61 3 9279 7200  
Fax: +61 3 9646 0474  
[www.corporatekeys.com.au](http://www.corporatekeys.com.au)

# Property Profile

## 'Freshwater' 1 Freshwater Place, Southbank

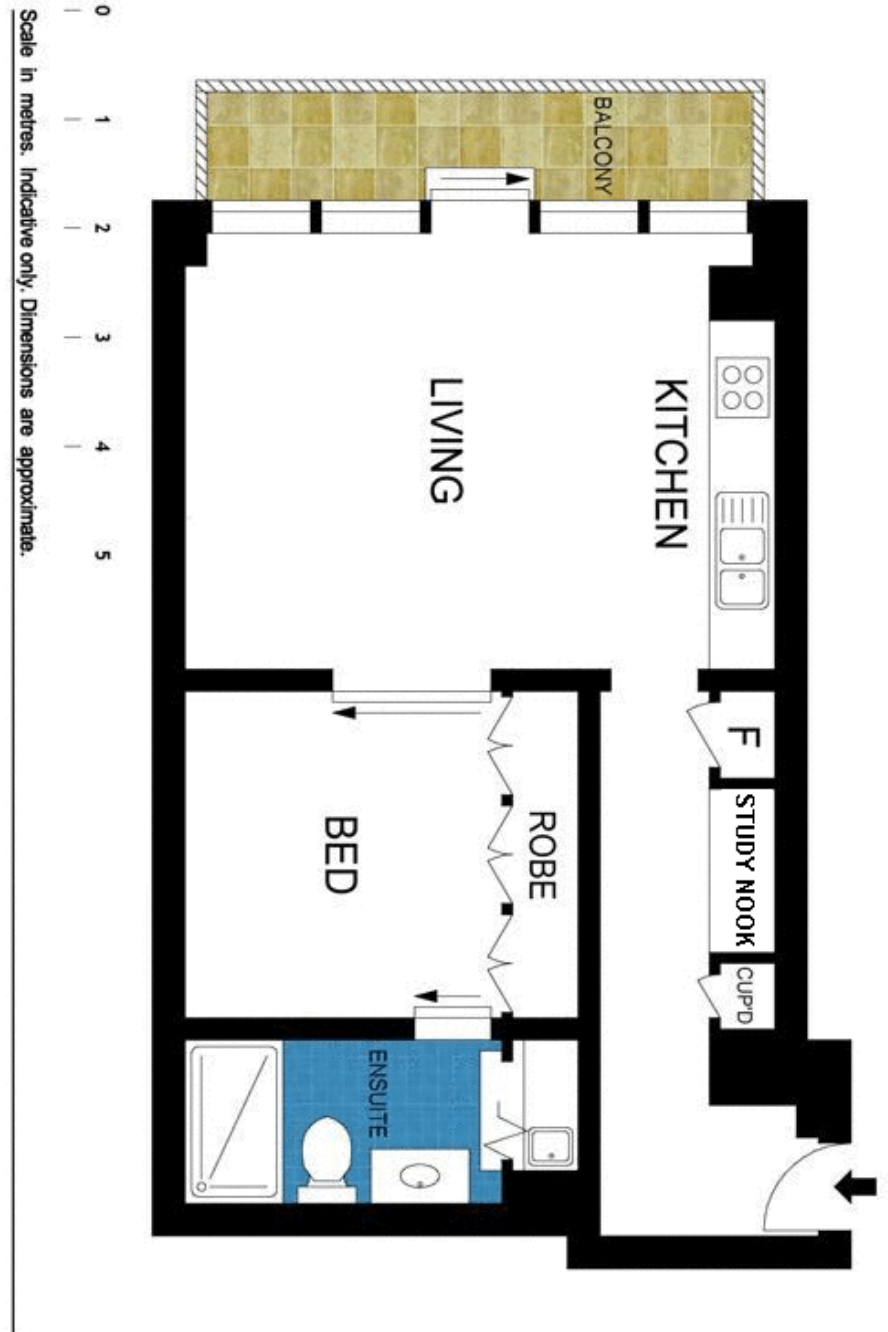

K113, 63 Turner Street  
Port Melbourne VIC 3207  
Ph: +61 3 9279 7200  
Fax: +61 3 9646 0474  
[www.corporatekeys.com.au](http://www.corporatekeys.com.au)